

AMERICAN QUEEN®

2020 CRUISE GUIDE



AMERICAN QUEEN®
STEAMBOAT COMPANY

Uniquely American River Cruises

2020 VOYAGE CALENDAR

 Lower Mississippi

 Upper Mississippi

DATE	DAYS	AMERICAN QUEEN ITINERARY	THEME
Feb 16	9	Roundtrip New Orleans <i>Ports: St. Francisville, Natchez, Vicksburg, Baton Rouge, Nottoway</i>	Southern Sampler
Feb 23	9	New Orleans to Memphis <i>Ports: Nottoway, St. Francisville, Natchez, Vicksburg, Port of the Mississippi Delta</i>	Mardi Gras on the River
Mar 1	9	Memphis to New Orleans <i>Ports: Port of the Mississippi Delta, Vicksburg, Natchez, Baton Rouge, St. Francisville, Nottoway</i>	Antebellum South
Mar 8	9	New Orleans to Memphis <i>Ports: Nottoway, St. Francisville, Natchez, Vicksburg, Port of the Mississippi Delta</i>	Antebellum South
Mar 15	9	Memphis to New Orleans <i>Ports: Port of the Mississippi Delta, Vicksburg, Natchez, Baton Rouge, St. Francisville, Nottoway</i>	Civil War
Mar 22	9	New Orleans to Memphis <i>Ports: Nottoway, St. Francisville, Natchez, Vicksburg, Port of the Mississippi Delta</i>	Antebellum South
Mar 29	9	Memphis to New Orleans <i>Ports: Port of the Mississippi Delta, Vicksburg, Natchez, Baton Rouge, St. Francisville, Nottoway</i>	Antebellum South
Apr 5	9	New Orleans to Memphis <i>Ports: Nottoway, St. Francisville, Natchez, Vicksburg, Port of the Mississippi Delta</i>	Antebellum South/Easter
Apr 12	9	Memphis to New Orleans <i>Ports: Port of the Mississippi Delta, Vicksburg, Natchez, Baton Rouge, St. Francisville, Nottoway</i>	Antebellum South
Apr 19	9	New Orleans to Memphis <i>Ports: Nottoway, St. Francisville, Natchez, Vicksburg, Port of the Mississippi Delta</i>	Antebellum South
Apr 26	9	Memphis to New Orleans <i>Ports: Port of the Mississippi Delta, Vicksburg, Natchez, Baton Rouge, St. Francisville, Nottoway</i>	Antebellum South
May 3	9	New Orleans to Memphis <i>Ports: Nottoway, St. Francisville, Natchez, Vicksburg, Port of the Mississippi Delta</i>	Antebellum South
May 10	9	Memphis to New Orleans <i>Ports: Port of the Mississippi Delta, Vicksburg, Natchez, Baton Rouge, St. Francisville, Nottoway</i>	Antebellum South
May 17	9	New Orleans to Memphis <i>Ports: Nottoway, St. Francisville, Natchez, Vicksburg, Port of the Mississippi Delta</i>	Antebellum South
May 24	9	Memphis to New Orleans <i>Ports: Port of the Mississippi Delta, Vicksburg, Natchez, Baton Rouge, St. Francisville, Nottoway</i>	Antebellum South
May 31	9	New Orleans to Memphis <i>Ports: Nottoway, St. Francisville, Natchez, Vicksburg, Port of the Mississippi Delta</i>	Antebellum South
Jun 7	9	Memphis to New Orleans <i>Ports: Port of the Mississippi Delta, Vicksburg, Natchez, Baton Rouge, St. Francisville, Nottoway</i>	Antebellum South
Jun 14	9	New Orleans to Memphis <i>Ports: Nottoway, St. Francisville, Natchez, Vicksburg, Port of the Mississippi Delta</i>	Antebellum South
Jun 21	9	Memphis to New Orleans <i>Ports: Port of the Mississippi Delta, Vicksburg, Natchez, Baton Rouge, St. Francisville, Nottoway</i>	Antebellum South
Jun 28	9	New Orleans to Memphis <i>Ports: Nottoway, St. Francisville, Natchez, Vicksburg, Port of the Mississippi Delta</i>	Antebellum South
Jul 5	9	Memphis to New Orleans <i>Ports: Port of the Mississippi Delta, Vicksburg, Natchez, Baton Rouge, St. Francisville, Nottoway</i>	Antebellum South
Jul 12	9	New Orleans to Memphis <i>Ports: Nottoway, St. Francisville, Natchez, Vicksburg, Port of the Mississippi Delta</i>	Antebellum South

DATE	DAYS	AMERICAN QUEEN ITINERARY	THEME
Jul 19	9	Memphis to Alton (St. Louis) <i>Ports: New Madrid, Paducah, Cape Girardeau, Chester, St. Louis</i>	American River BBQ Challenge
Jul 26	9	Alton (St. Louis) to Red Wing (Minneapolis) <i>Ports: Hannibal, Clinton, Dubuque, La Crosse, Red Wing</i>	Mark Twain's Mississippi
Aug 2	9	Red Wing (Minneapolis) to Alton (St. Louis) <i>Ports: Red Wing, La Crosse, Dubuque, Bettendorf (Quad Cities), Burlington, Hannibal</i>	Mark Twain's Mississippi
Aug 9	9	Alton (St. Louis) to Red Wing (Minneapolis) <i>Ports: Hannibal, Clinton, Dubuque, La Crosse, Red Wing</i>	Mark Twain's Mississippi
Aug 16	16	Red Wing (Minneapolis) to New Orleans <i>Ports: Winona, La Crosse, Dubuque, Bettendorf (Quad Cities), Burlington, Hannibal, St. Louis, Memphis, Port of the Mississippi Delta, Vicksburg, Natchez, Nottoway</i>	 THE MIGHTY MISSISSIPPI 
Aug 30	9	New Orleans to Memphis <i>Ports: Nottoway, St. Francisville, Natchez, Vicksburg, Port of the Mississippi Delta</i>	Antebellum South
Sep 6	9	Memphis to New Orleans <i>Ports: Port of the Mississippi Delta, Vicksburg, Natchez, Baton Rouge, St. Francisville, Nottoway</i>	Antebellum South
Sep 13	9	New Orleans to Memphis <i>Ports: Nottoway, St. Francisville, Natchez, Vicksburg, Port of the Mississippi Delta</i>	Antebellum South
Sep 20	9	Memphis to New Orleans <i>Ports: Port of the Mississippi Delta, Vicksburg, Natchez, Baton Rouge, St. Francisville, Nottoway</i>	Antebellum South
Sep 27	9	New Orleans to Memphis <i>Ports: Nottoway, St. Francisville, Natchez, Vicksburg, Port of the Mississippi Delta</i>	Antebellum South
Oct 4	9	Memphis to New Orleans <i>Ports: Port of the Mississippi Delta, Vicksburg, Natchez, Baton Rouge, St. Francisville, Nottoway</i>	Antebellum South
Oct 11	9	New Orleans to Memphis <i>Ports: Nottoway, St. Francisville, Natchez, Vicksburg, Port of the Mississippi Delta</i>	Antebellum South
Oct 18	9	Memphis to New Orleans <i>Ports: Port of the Mississippi Delta, Vicksburg, Natchez, Baton Rouge, St. Francisville, Nottoway</i>	Antebellum South
Oct 25	9	New Orleans to Memphis <i>Ports: Nottoway, St. Francisville, Natchez, Vicksburg, Port of the Mississippi Delta</i>	Antebellum South
Nov 1	9	Memphis to New Orleans <i>Ports: Port of the Mississippi Delta, Vicksburg, Natchez, Baton Rouge, St. Francisville, Nottoway</i>	Antebellum South
Nov 8	9	New Orleans to Memphis <i>Ports: Nottoway, St. Francisville, Natchez, Vicksburg, Port of the Mississippi Delta</i>	Antebellum South
Nov 15	9	Memphis to New Orleans <i>Ports: Port of the Mississippi Delta, Vicksburg, Natchez, Baton Rouge, St. Francisville, Nottoway</i>	Civil War
Nov 22	9	New Orleans to Memphis <i>Ports: Nottoway, St. Francisville, Natchez, Vicksburg, Port of the Mississippi Delta</i>	Plantation Thanksgiving
Nov 29	9	Memphis to New Orleans <i>Ports: Port of the Mississippi Delta, Vicksburg, Natchez, Baton Rouge, St. Francisville, Nottoway</i>	Plantation Holidays
Dec 6	9	New Orleans to Memphis <i>Ports: Nottoway, St. Francisville, Natchez, Vicksburg, Port of the Mississippi Delta</i>	Plantation Holidays
Dec 13	9	Memphis to New Orleans <i>Ports: Port of the Mississippi Delta, Vicksburg, Natchez, Baton Rouge, St. Francisville, Nottoway</i>	Plantation Holidays
Dec 20	9	Roundtrip New Orleans <i>Ports: Nottoway, St. Francisville, Natchez, Vicksburg</i>	Creole Christmas
Dec 27	9	Roundtrip New Orleans <i>Ports: Nottoway, St. Francisville, Natchez, Vicksburg</i>	New Year's Eve Celebration

DECK PLANS

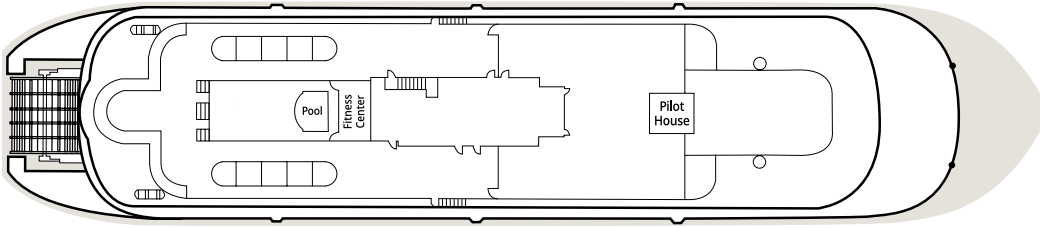

DECK 6 – SUN DECK

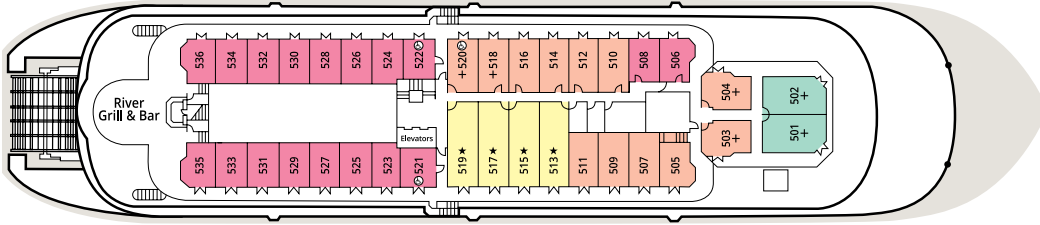

DECK 5 – PROMENADE DECK

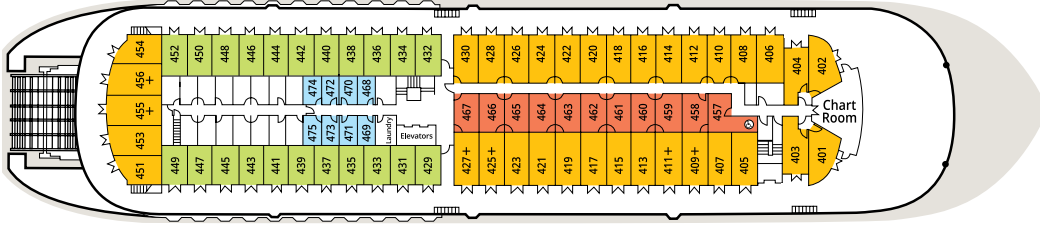

DECK 4 – OBSERVATION DECK

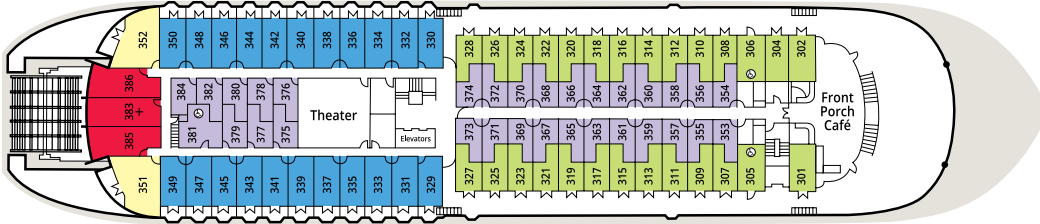

DECK 3 – TEXAS DECK

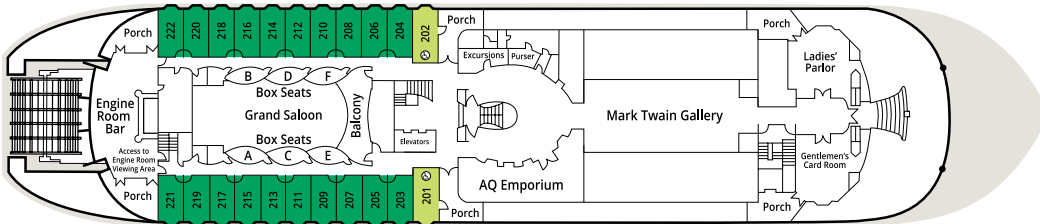

DECK 2 – CABIN DECK

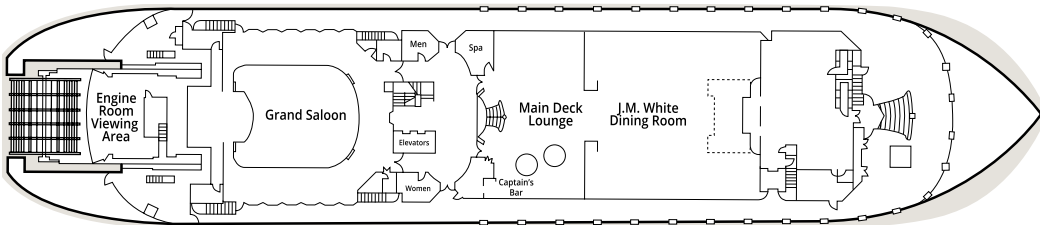

DECK 1 – MAIN DECK

SUITE AND STATEROOM CATEGORIES

- OS** OWNER'S SUITES WITH EXCLUSIVE VERANDA
- LS** LUXURY SUITES WITH PRIVATE OR OPEN VERANDA
- DS** DELUXE SUITES WITH OPEN VERANDA
- JS** JUNIOR SUITES WITH OPEN VERANDA
- PS** PADDLEWHEEL STATEROOMS
- A** DELUXE OUTSIDE STATEROOMS WITH PRIVATE VERANDA
- B** OUTSIDE STATEROOMS WITH OPEN VERANDA
- C** OUTSIDE STATEROOMS WITH OPEN VERANDA
- D** DELUXE OUTSIDE STATEROOMS WITH BAY WINDOW
- E** INSIDE STATEROOMS
- SD** SINGLE DELUXE STATEROOMS
- SI** SINGLE INSIDE STATEROOMS

+ TRIPLE OCCUPANCY

★ QUADRUPLE OCCUPANCY

ACCESSIBLE SUITES AND STATEROOMS

SPECIFICATIONS

YEAR BUILT 1995
REFURBISHED 2017
LENGTH 418 FEET
PASSENGER DECKS 6
SUITES AND STATEROOMS 218
PASSENGERS 417
CREW 172

SUITES AND STATEROOMS

OS OWNER'S SUITES WITH EXCLUSIVE VERANDA

Open your French doors and step out onto your veranda to unwind on your amply furnished patio. Adorned with 11-foot vaulted ceilings, overhead lighting and a cozy interior lounging area with a sofa-bed and cocktail tables, these expansive suites can accommodate up to three guests, and they epitomize luxurious river cruising. Relish the many exclusive benefits of our *Commodore Services* while being attended to by your personal River Butler.

- ★ 348 sq. ft. with 690-sq.-ft. exclusive veranda
- ★ Queen bed
- ★ Full bathroom with tub/shower combination
- ★ Lounging area with sofa-bed
- ★ Dressing area with granite vanity and mirror
- ★ Flat-screen TV
- ★ Coffee maker and mini refrigerator
- ★ French doors open to exclusive veranda
- ★ Furnished patio with sofa, two chairs and a coffee table
- ★ Interior and exterior access
- ★ Promenade Deck
- ★ *Commodore Services*, including a River Butler

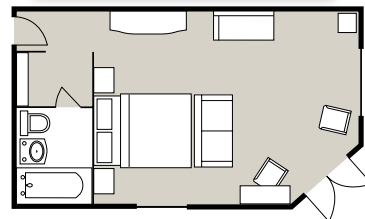

LS LUXURY SUITES WITH PRIVATE OR OPEN VERANDA

Our spacious, elegant suites are furnished to provide the warm ambiance of a fine Southern estate. Open your French doors and delight in sweeping river views as you sip a beverage and share conversation in your cozy sitting area. With two configurations to choose from – either one large room with a private veranda or two adjoining rooms with an open veranda – these suites are the ideal choice for family and friends vacationing together.

- ★ 353-363 sq. ft. with private or open veranda
- ★ Queen bed or two single beds
- ★ Full bathroom with tub and shower or tub/shower combination
- ★ Sitting area with sofa-bed
- ★ Vanity, mirror and desk
- ★ Flat-screen TV
- ★ Coffee maker and mini refrigerator
- ★ French doors open to deck or veranda
- ★ Interior and exterior access
- ★ Promenade and Texas Decks
- ★ *Commodore Services*, including a River Butler

It is important to note that our Luxury Suites, located on the Texas Deck, are in close proximity to the paddlewheel. While many guests love the allure of the traditional paddlewheel experience, others may find the authentic turning of the paddlewheel to be slightly noisier than they would like at times.

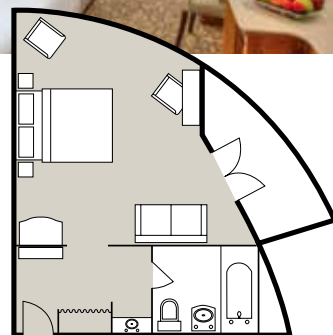

LS Suites on Texas Deck



LS Suites on Promenade Deck

DS DELUXE SUITES WITH OPEN VERANDA

You will feel right at home on the river in our magnificent suites. Indulge in a soothing soak in your tub, and then retire to your cozy armchair or sofa, prop your feet up on the ottoman, and read through the *River Times* – our daily program – to discover the delights that await.

- ★ 230 sq. ft. with open veranda
- ★ Queen bed or two single beds
- ★ Full bathroom with tub/shower combination
- ★ Sitting area with sofa-bed
- ★ Vanity and mirror
- ★ Flat-screen TV
- ★ French doors open to deck
- ★ Interior and/or exterior access
- ★ Promenade Deck
- ★ *Commodore Services* (excludes River Butler)

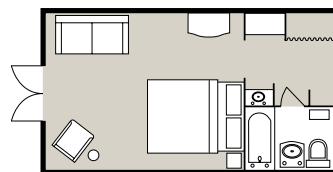

JS JUNIOR SUITES WITH OPEN VERANDA

Settle into your sitting area, open the French doors to the deck, and greet the day as the banks of the river slip majestically by. Some staterooms in this category offer a view of the paddlewheel, while others provide expansive views of America's heartland.

- ★ 210 sq. ft. with open veranda
- ★ Queen bed or two single beds
- ★ Full bathroom with tub/shower combination
- ★ Flat-screen TV
- ★ Sitting area
- ★ Vanity and mirror
- ★ French doors open to deck
- ★ Interior and/or exterior access
- ★ Promenade and Observation Decks
- ★ Preferred dining arrangements

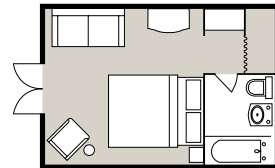

PS PADDLEWHEEL STATEROOMS

These spacious retreats offer unmatched views, each with a 6-foot-square viewing window that overlooks the paddlewheel, for a truly authentic steamboating experience. It is important to note that while some guests are enamored with the allure of the more traditional experience, others may find the turning of the paddlewheel to produce more sound and vibration than they like at times.

- ★ Stateroom 383 (342 sq. ft.)
- ★ Staterooms 385 and 386 (302 sq. ft.)
- ★ Traditional paddlewheel experience
- ★ Queen bed or two single beds
- ★ Full bathroom with tub/shower combination
- ★ Flat-screen TV
- ★ Sitting area with sofa-bed
- ★ 6-foot-square picture window overlooking the paddlewheel
- ★ Vanity, mirror and desk
- ★ Interior access
- ★ Texas Deck

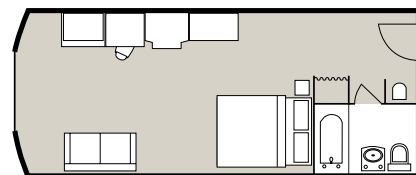

A DELUXE OUTSIDE STATEROOMS WITH PRIVATE VERANDA

With a private veranda, these staterooms are so enjoyable that you might decide to extend your journey. Relax in a cozy armchair and enjoy the view as you anticipate the activities of the day.

- ★ 190 sq. ft. with 40-sq.-ft. private veranda
- ★ Queen bed or two single beds
- ★ Full bathroom with tub/shower combination
- ★ Flat-screen TV
- ★ French doors open to private veranda
- ★ Interior access
- ★ Texas Deck

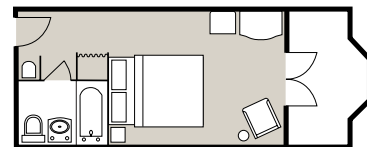

B OUTSIDE STATEROOMS WITH OPEN VERANDA

Can you imagine opening French doors to a sweeping river vista and the sweet scent of magnolia trees? Sit on the deck outside your stateroom and greet early-morning strollers, relax in bed with your favorite book or soak in a hot bath.

- ★ 190-205 sq. ft. with open veranda
- ★ Queen bed or two single beds
- ★ Full bathroom with tub/shower combination
- ★ Flat-screen TV
- ★ French doors open to deck
- ★ Interior and/or exterior access
- ★ Observation Deck

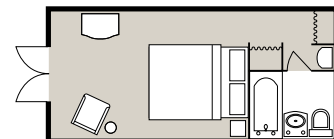

Note: Stateroom information provided is a general representation of the stateroom categories. Actual room configurations, features and amenities may vary slightly among and within stateroom categories.

C OUTSIDE STATEROOMS WITH OPEN VERANDA

Open your French doors, and enjoy the fresh air. Sit on the deck outside your stateroom, and take in the gently changing views of the landscape, or indulge in a leisurely morning in bed with room service.

- ★ 140-160 sq. ft. with open veranda
- ★ Queen bed or two single beds
- ★ Full bathroom with shower or tub/shower combination
- ★ Flat-screen TV
- ★ French doors open to deck
- ★ Exterior access
- ★ Observation, Texas and Cabin Decks

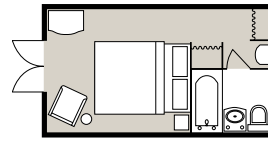

C Staterooms

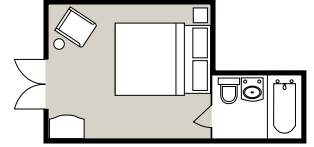

C Staterooms on Texas Deck

D DELUXE OUTSIDE STATEROOMS WITH BAY WINDOW

An expansive bay window overlooking the scenery of America's heartland is the main draw of this spacious category. Curl up in front of the window with a new novel, and savor a moment that belongs to only you.

- ★ 190 sq. ft. with bay window
- ★ Queen bed or two single beds
- ★ Full bathroom with tub/shower combination
- ★ Flat-screen TV
- ★ Interior access
- ★ Cabin Deck

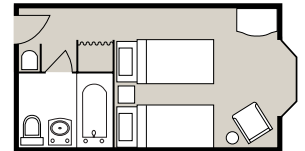

SD SINGLE DELUXE STATEROOMS

Greet the day in your cozy stateroom, relaxing before breakfast or just enjoying a leisurely morning in bed with room service.

- ★ 140 sq. ft. (ADA room is 167 sq. ft.)
- ★ Queen bed
- ★ Full bathroom with shower or tub/shower combination
- ★ Flat-screen TV
- ★ Interior access
- ★ Observation Deck

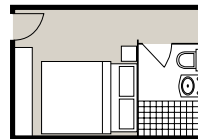

E INSIDE STATEROOMS

Surrounded by wonderful period details, but with every modern convenience, these cozy havens will make your cares disappear. Ample shelving and storage spaces keep your necessities out of the way but easily accessible.

- ★ 132 sq. ft. (ADA room is 217 sq. ft.)
- ★ Queen bed or two single beds
- ★ Full bathroom with shower
- ★ Flat-screen TV
- ★ Interior access
- ★ Texas Deck

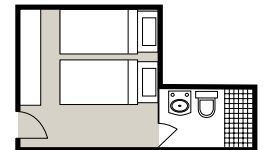

SI SINGLE INSIDE STATEROOMS

These intimate cabins with ample storage space are slightly scaled down to accommodate the independent traveler, and feature a single bed.

- ★ 80 sq. ft.
- ★ Queen bed or two single beds
- ★ Full bathroom with shower
- ★ Flat-screen TV
- ★ Interior access
- ★ Texas Deck

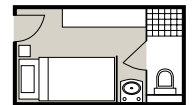

Guests holding reservations for *suite-level* accommodations will receive exclusive benefits and services, including pre-boarding privileges, a bottle of wine and a fruit basket upon arrival, preferred dining arrangements, reserved seating in the Grand Saloon, River Butler service and more. **River Butler service is limited to suite categories OS and LS.**

UNIQUELY AMERICAN RIVER CRUISES®

REGIONALLY INSPIRED FINE DINING



BROADWAY-CALIBER ENTERTAINMENT AND ENRICHMENT



COMPREHENSIVE, GUIDED SHORE EXCURSIONS



AUTHENTIC PADDLEWHEEL RIVERBOATS



AMERICAN DUCHESS



AMERICAN QUEEN



AMERICAN EMPRESS



AMERICAN COUNTESS



AMERICAN QUEEN®
STEAMBOAT COMPANY